

N-Style Vanstone Tapered Thermowells

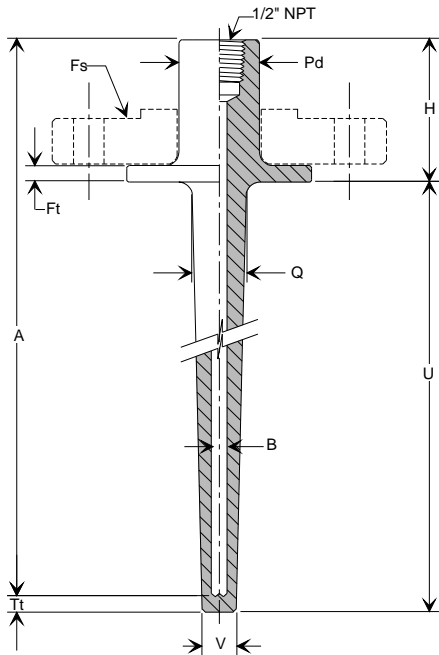

N Fs Pr Ft H Pd U Tt A M B Q V O

FS- Flange Size

1", 1-1/2", and 2", refer to table 1.3 on page 11
Other

Pr- Flange Rating

150#, 300#, 400#, 600#, 900#, 1500# and 2500#

Ft- Flange Thickness

0.375" (9.5)

Other

H - Head Length

2.250" (57.2)

3.250" (82.6)

Other

Pd- Pipe Diameter

1.315" (33.4), for 1" flange size

1.900" (48.3), for 1-1/2" flange size

2.375" (60.3), for 2" flange size

Other

U - Insertion Length

decimal units

Tt - Tip Thickness

0.250" (6.4)

Other

A - Stem Length

decimal units

M - Material

refer to table 2.0 on page 23

B - Bore Size

0.260 (6.6)

0.385 (9.8)

Other

Q - Root Diameter

1.063" (27.0), refer to table 1.5 on page 11

Other, refer to table 1.5 on page 11

V - Tip Diameter

0.625, (15.9)

0.750", (19.1)

Other

O - Options

refer to page 22

Notes **Sample Part No.:** N15 - 150# - 0.375" - 3.250" - 2.375" - 6.000" - 0.250" - 9.000" -R/RL - 0.260" - 1.063" - 0.750" - DR11a, SC3

1. Most Vanstone thermowells are fabricated from one piece bar stock. A two piece construction could be considered for economic reasons.
2. Contact a sales representative when requiring a thermowell not listed in this catalogue.
3. Metric dimensions are in brackets.