



## Model 3500 Pressure Vent with Pipe-Away

### OBJECTIVE

The Model 3500 conservation pressure vent with pipe-away is intended for use where pressure relief is required and the relieving vapors must be piped away and not emitted into the atmosphere. May also be used for in-line vacuum relief.

### TECHNIQUE

A weight loaded pallet opens and closes allowing the discharge of vapors to the outlet piping to maintain the tank pressure within permissible limits to avoid damage to the tank. A flanged side outlet connection is provided for easy pipe-away of vapors, eliminating their emission into the atmosphere, and allowing compliance with applicable regulations.

### CONSTRUCTION

**Housing Material:** Available in Aluminum, Carbon Steel, 316 Stainless Steel or Corrosion Resistant Fiberglass.

**Trim Material:** 316 SST - Standard on all metal vents.  
Fiberglass - Standard on all FRP vents.

**Pallet Diaphragm Material:** FEP Teflon - Standard. Other materials available on request.

### SPECIAL FEATURES

**Modular.** The Model 3500 pressure only vent with pipe-away is part of the Valve Concepts, Ince. modular vent product line. The Model 3500 is used in the 3200, 4200, and 5200 pressure/vacuum vents with pipeaway and the Model 3600 side mounted vacuum vent.

**Easy Maintenance.** The Model 3500 vent is a rugged design and made to last.

**Maintains Accurate Settings.** The minimum setting available is ½ oz/in<sup>2</sup>. For all sizes the maximum pressure setting is 3 psig. If higher settings are required see Valve Concepts Series 4500 Spring Loaded Vent or Valve Concepts Series 5500 Pilot Operated Vent. All vents are tested to Valve Concepts, Inc. high standard for leakage and set point prior to shipment. A certified test certificate is included with each vent verifying the accuracy. A leakage rate of less than 1 SCFH at 90% of set point is verified.

**Condensate Drainage.** Self-draining housing body and drip rings keep condensate away from seating surfaces, preventing freezing, binding and clogging.

**Air-Cushioned Seating.** Air-cushion seating provides tight sealing to reduce evaporation losses. The pallets have outer guiding and center stabilizing stem to provide self alignment and tight seating.

**Numerous Sizes Available.** All CS and SST vents sizes 2-inch thru 12-inch mate with standard ANSI RF flange. All Aluminum and FRP vents mate with 125# flat face flange. On sizes 2-inch thru 6-inch the Model 3500 is available with the same size inlet and outlet to reduce outlet piping cost.

TABLE 1

MATERIALS OF CONSTRUCTION			
Series	Housing	Pallets *	Seats
3500CS	CS	316 SST	Teflon®
3500SST	316 SST	316 SST	Teflon®
3500D	Derakane® 470	Derakane® 470	Teflon®
3500E	Derakane® 411	Derakane® 411	Teflon®
3500F	Furan	Furan	Teflon®
3500ALUM	Aluminum	316 SST	Teflon®

\* On Aluminum and CS vents, weights are steel or lead. On SST vents, weights are SST or lead. On FRP vents, weights are steel, SST or lead and can be FRP encapsulated. Other weight material available on request.

# SPECIFICATIONS

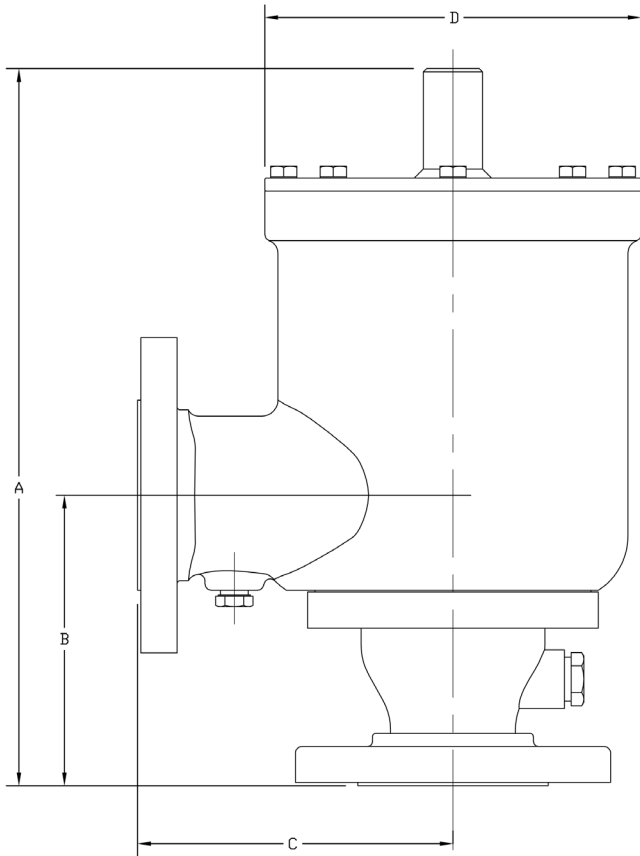

DIMENSIONS – Standard Construction for Carbon Steel & Stainless Steel Housing & Pallets				
SIZE	A	B	C	D
2" x 2"	13.65"	5.53"	6.00"	Dia. 7.16"
2" x 3"	13.65"	6.09"	6.19"	Dia. 7.16"
3" x 3"	16.01"	6.66"	6.50"	Dia. 8.00"
3" x 4"	16.01"	7.16"	6.50"	Dia. 8.00"
4" x 4"	19.52"	8.78"	8.00"	Dia. 10.75"
4" x 6"	19.52"	9.78"	8.00"	Dia. 10.75"
6" x 6"	21.82"	10.48"	9.00"	Dia. 12.38"
6" x 8"	22.16"	11.63"	9.00"	Dia. 12.38"
8" x 10"	25.50"	13.67"	11.00"	Dia. 15.24"
10" x 12"	28.91"	15.59"	12.25"	Dia. 18.25"
12" x 14"	35.61"	21.18"	14.00"	Dia. 19.00"

DIMENSIONS – Standard Construction for Corrosion Resistant Fiberglass Housing & Pallets				
SIZE	A	B	C	D
2" x 2"	13.65"	5.53"	6.00"	Dia. 7.16"
2" x 3"	13.65"	6.09"	6.19"	Dia. 7.16"
3" x 3"	16.01"	6.66"	6.50"	Dia. 8.00"
3" x 4"	16.01"	7.16"	6.50"	Dia. 8.00"
4" x 4"	19.52"	8.78"	8.00"	Dia. 10.75"
4" x 6"	19.52"	9.78"	8.00"	Dia. 10.75"
6" x 6"	21.82"	10.48"	9.00"	Dia. 12.38"
6" x 8"	22.16"	11.63"	9.00"	Dia. 12.38"
8" x 10"	25.50"	13.67"	11.00"	Dia. 15.24"
10" x 12"	28.91"	15.59"	12.25"	Dia. 18.25"
12" x 14"	35.61"	21.18"	14.00"	Dia. 19.00"

## 3500 Series PRODUCT CODE

04/24/06

**35**

Table 1

Table 2

Table 3

**A**

**NOTES:**

- \* 8" inlet only available w/10" outlet.
- 10" inlet only available w/12" outlet.
- 12" inlet only available w/14" outlet.

TABLE 1 SIZE	
Inlet Size	CODE
2"	2
3"	3
4"	4
6"	6
8"	8 *
10"	A *
12"	B *

TABLE 2 SIZE	
Outlet Size	CODE
2"	2
3"	3
4"	4
6"	6
8"	8
10"	A
12"	B
14"	C

TABLE 2 - BODY/STUDS & NUTS MATERIALS		
Material	W/O Flamescreen	W/ Flamescreen
	CODE	CODE
CS/SST	C	D
SST/SST	S	T
Derakane 470/SST	F	
Derakane 470/Hastelloy	H	
Derakane 411/SST	K	
Derakane 411/Hastelloy	L	
Furan/SST	G	
Furan/Hastelloy	J	
ALUM./SST	A	B

Valve Concepts, Inc.  
 A Cashco Company  
 607 W. 15th Street  
 Ellsworth, KS 67439  
 PH (785) 472-4461  
 Fax. # (785) 472-3539  
 www.valveconcepts.com  
 email: vcisales@cashco.com  
 Printed in U.S.A. Model 3500 TB