



## Model 3600

### Side-Mounted Vacuum Relief Vent

#### OBJECTIVE

The Model 3600 vacuum relief vents are intended for use on atmospheric and low pressure tanks, vapor recovery systems and process systems where vacuum relief is required. Built for dependable service and superior seat tightness, these durable vents are designed to be mounted to the tank structure or process piping.

#### TECHNIQUE

The weight loaded pallet in the vent housing allows the intake of air necessary to maintain the tank pressure within the permissible vacuum limit to avoid damage to the tank. Once the vacuum condition is satisfied and the pressure is within the permissible limits the pallet closes. The model 3600 virtually eliminates the intake of air except during normal tank in breathing.

#### CONSTRUCTION

**Housing Material:** Available in Aluminum, Carbon Steel, 316 Stainless Steel or Corrosion Resistance Fiberglass.

**Trim Material:** 316 SST - Standard on all metal vents. Fiberglass - Standard on all FRP vents except for the cover studs which are either 316 SST or Monel and do not see process vapors.

**Pallet Diaphragm Material:** FEP Teflon - Standard. Other materials available on request.

#### SPECIAL FEATURES

**Modular.** The Model 3600 side mounted vacuum vent is part of the Valve Concepts, Inc. modular vent product line. The 3600 is used in the pressure / vacuum vent with pipe-away and the pressure only vent with pipe-away. These vents can either be direct acting (weight-loaded or spring-loaded) or pilot operated.

**Maintains Accurate Vacuum Settings.** The pallet is fabricated to the precise weight necessary to maintain an accurate vacuum setting. The minimum setting available is ½ oz/in<sup>2</sup> and the maximum vacuum setting is 1 psig on all sizes. As with every vent supplied by Valve Concepts, Inc. a Certified Test Certificate is included verifying the accuracy of both set point and leakage rate. On all direct acting vents supplied by Valve Concepts the leakage is less than 1 SCFH at 90% of set point. The standard unit is suitable for intermittent back pressures of 2 psig. Higher back pressure ratings are available on request.

**Condensate Drainage.** Self-draining housing body and drip rings keep condensate away from seating surfaces, preventing freezing, binding and clogging.

**Air-Cushioned Seating.** Air-cushion seating for low evaporation losses. The pallets have outer guiding and center stabilizing stem to provide self alignment and tight seating.

**Numerous Sizes Available.** All CS and SST vents sizes 2-inch thru 12-inch mate with standard ANSI flange connections. All Aluminum and FRP vents mate with 125# flat face flange.

TABLE 1

MATERIALS OF CONSTRUCTION			
Series	Housing	Pallets *	Seats
3600CS	CS	316 SST	Teflon®
3600SST	316 SST	316 SST	Teflon®
3600D	Derakane® 470	Derakane® 470	Teflon®
3600E	Derakane® 411	Derakane® 411	Teflon®
3600F	Furan	Furan	Teflon®
3600ALUM	Aluminum	316 SST	Teflon®

\* On Aluminum and CS vents, weights are steel or lead. On SST vents, weights are SST or lead. On FRP vents, weights are steel, SST or lead and can be FRP encapsulated. Other weight material available on request.

# SPECIFICATIONS

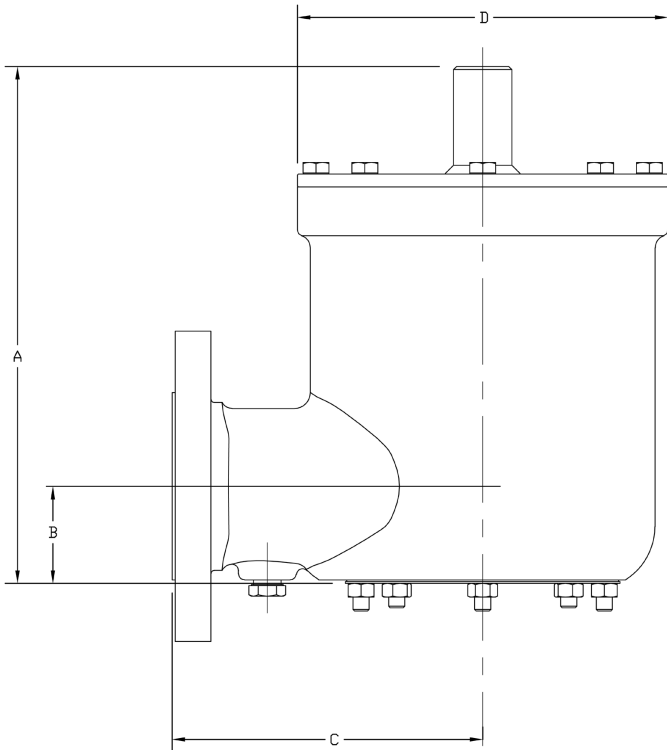

DIMENSIONS – Standard Construction for Carbon Steel & Stainless Steel Housing & Pallets				
SIZE	A	B	C	D
2"	9.97"	1.88"	6.00"	Dia. 7.16"
3"	11.69"	2.38"	6.50"	Dia. 8.00"
4"	13.64"	2.94"	8.00"	Dia. 10.75"
6"	15.28"	3.97"	9.00"	Dia. 12.38"
8"	15.94"	5.00"	9.00"	Dia. 12.38"
10"	17.97"	6.19"	11.00"	Dia. 15.24"
12"	20.38"	7.06"	12.25"	Dia. 18.25"
14"	22.12"	7.66"	14.00"	Dia. 19.00"
DIMENSIONS – Standard Construction for Corrosion Resistant Fiberglass Housing & Pallets				
SIZE	A	B	C	D
2"	10.23"	1.29"	7.50"	Dia. 8.38"
3"	10.29"	1.79"	7.50"	Dia. 8.38"
4"	13.12"	2.28"	9.00"	Dia. 12.75"
6"	13.77"	3.29"	9.50"	Dia. 12.75"
8"	13.77"	4.25"	9.50"	Dia. 12.75"
10"	17.50"	5.26"	12.00"	Dia. 16.75"
12"	19.13"	6.25"	12.00"	Dia. 16.38"
14"	21.54"	6.88"	13.00"	Dia. 18.50"

## 3600 Series PRODUCT CODE

04/24/06



TABLE 1 SIZE	
Size	CODE
2"	2
3"	3
4"	4
6"	6
8"	8
10"	A
12"	B
14"	C

Material	TABLE 2 - BODY/STUDS & NUTS MATERIALS	
	W/O Flamescreen	W/ Flamescreen
	CODE	CODE
CS/SST	C	D
SST/SST	S	T
Derakane 470/SST	F	
Derakane 470/Hastelloy	H	
Furan/SST	G	
Furan/Hastelloy	J	
Derakane 411/SST	K	
Derakane 411/Hastelloy	L	
ALUM./SST	A	B

Valve Concepts, Inc.  
 A Cashco Company  
 607 W. 15th Street  
 Ellsworth, KS 67439  
 PH (785) 472-4461  
 Fax. # (785) 472-3539  
 www.valveconcepts.com  
 email: vcisales@cashco.com  
 Printed in U.S.A.      Model 3600 TB