

Model 1465-80

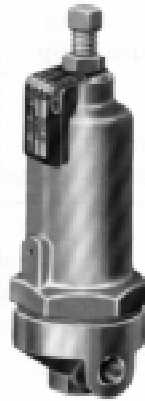

MODEL 1465

PRESSURE REDUCING REGULATOR

The Model 1465 is for small flows and is used primarily when sampling a fluid for analytical purposes. The 316 SST body can handle inlet pressures as high as 5000 psig (344 Barg).

FEATURES

High Pressure Drop Capabilities: Pressure drops to 4700 psi (324 Barg).

Trim Material Combinations: Four to choose from.

Two Trim Sizes: 0.05 and 0.19 C_v orifices used.

Non-Asbestos: Utilizes diaphragm O-ring of TFE.



Model 1465



APPLICATIONS

Designed to control a wide range of fluids including natural gas, inert gases, sour gas, steam, chemicals and water. Used to reduce pressure for analytical sampling. See Table 1 for more information.

STANDARD / GENERAL SPECIFICATIONS

Body Size: 1/4" (DN6) with NPT female pipe connections. Bottom inlet and side outlet.

Body Material: ASTM A351, Gr. CF8M; Investment Cast 316 SST.

Spring Chamber: *Standard:* Cast bronze; ASTM B62, Alloy C83600.
Optional: SST; see Option -60.

Diaphragms: 302 SST, Neoprene or Elgiloy. See Table 3.

Trim: SST; metallic seated. See Table 3.

C_v's:

Orifice Size	Minimum Controllable Cv	Max. Cv
0.109	0.0005	0.05
0.156	0.002	0.19

Diaphragm O-ring: TFE.

Operating Temperature: -20 to +400°F (-29 to +205°C). See Tables 2 and 3.

Maximum Leakage Rate: Less than 50 standard cubic centimeters per minute. Air at 100 psig (6.9 Barg) in and Atmosphere out.

Inlet Pressure: Up to 5000 psig (344 Barg) maximum.

Range Spring and Maximum Pressure Drop: Plated Steel.

Spring Range		Max Pressure Drop
psig	(Barg)	psig (Barg)
5-30	(.34-2.1)	*1000 (68.9)
10-80	(.69-5.5)	2500 (172.4)
70-140	(4.8-9.6)	3000 (206.9)
125-200	(8.6-13.8)	3500 (241.3)
180-300	(12.4-20.7)	4000 (275.8)
Option-80		
270-400	(18.6-27.6)	4700 (324.1)
360-500	(24.8-34.5)	4600 (317.2)

* See Figure 2 and associated text.

OPTION SPECIFICATIONS

Option-2: HANDWHEEL. Plastic handwheel on standard unit; aluminum handwheel for Option -2+80. Utilize for frequent setpoint changes.

Option-22: PANEL MOUNTING. Includes a mounting nut and a handwheel.

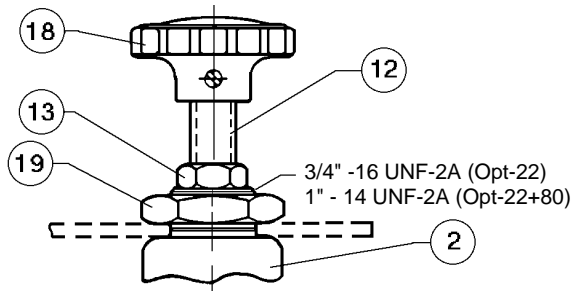

Figure 1: Option -22 Panel Mounting (handwheel portion is same for Option -2 Handwheel)

Option-40 SST: SST NACE CONSTRUCTION. Internal wetted portions meet NACE standard MR0175 when the exterior of the regulator is not directly exposed to a

sour gas environment, buried, insulated or otherwise denied direct atmospheric exposure. 316 SST body/spring chamber material only. S40 and S40M only trim selections available. Not available with Option -80.

Option-55: SPECIAL CLEANING. Cleaning per Cashco Spec. #S-1134. Acceptable cleaning level for oxygen gas service.

Option-60: SST SPRING CHAMBER. Standard bronze spring chamber is replaced with cast SST material per ASTM A351, Gr. CF3M. Not available with Option -80.

Option-80: HIGH OUTLET PRESSURE. For controlling outlet pressure above 300 psig (20.7 Barg) setpoint. Includes a cast aluminum bronze spring chamber, ASTM B-148, Alloy C95500, for spring ranges from 270 to 500 psig (18.6 to 34.5 Barg). S1 and S40M only trim selections available.

TECHNICAL SPECIFICATIONS

**TABLE 1
APPLICATIONS**

Fluid	Recommended Construction	Trim Designation Number
Air or Inert Gases	Metal Seat and Composition Diaphragm	S3
Chemicals	Metal Seat and Diaphragm	S1 or S40M
	Metal Seat and Composition Diaphragm	S3 or S40
Sour Gas	Metal Seat and Diaphragm	S40M
	Metal Seat and Composition Diaphragm	S40
Hydrocarbon Gas or Liquids	Metal Seat and Diaphragm	S1
	Metal Seat and Composition Diaphragm	S3
Water and Condensate	Metal Seat and Diaphragm	S1
	Metal Seat and Composition Diaphragm	S3
Steam	Metal Seat and Diaphragm	S1

**TABLE 2
BODY AND SPRING CHAMBER
MAXIMUM OUTLET PRESSURE AND TEMPERATURE RATINGS**

SST Body Materials with:	Outlet Pressure		Temperature	
	psig	(Barg)	°F	(°C)
Standard BRZ Spring Chamber	400	(27.6)	-20 to +400	(-29 to +205)
SST Spring Chamber	600	(41.4)	-20 to +400	(-29 to +205)
OPT-80 (BRZ Spring Chamber)	600	(41.4)	-20 to +400	(-29 to +205)

**TABLE 3
STAINLESS STEEL TRIM MATERIAL COMBINATIONS**

Part	Stainless Steel Trim Designation Number			
	S1	S3	S40	S40M
Diaphragm	302 SST	Neoprene	Neoprene	¹ Elgiloy
Plug	Chrome Plated	Chrome Plated	Chrome Plated	Chrome Plated
	316 SST	316 SST	316 SST	316 SST
Seat	Stellite #6B	Stellite #6B	Stellite #6B	Stellite #6B
Spring	302 SST	302 SST	Inconel X-750	Inconel X-750
Spring Seat	316 SST	316 SST	316 SST	316 SST
Pusher Plate	316 SST	316 SST	316 SST	316 SST
Temperature Range	-20 to +400°F	-20 to +180°F	-20 to +180°F	-20 to +400°F
	(-29 to +205°C)	(-29 to +83°C)	(-29 to +83°C)	(-29 to +205°C)

¹ Elgiloy HRC 60 Max. — Elgiloy Company

Figure 2: High Pressure Steam, Water or Condensate.
Applications involving these fluids should be considered for cavitation. The above fluids are typically cooled to 80° to 120°F (27° to 49°C) before pressure is reduced. Figure 2 graphically indicates where cavitation can be expected. If a selection ends in the "cavitating zone", then multiple Model 1465's should be used in series to stage the pressure drops to eliminate cavitation damage.

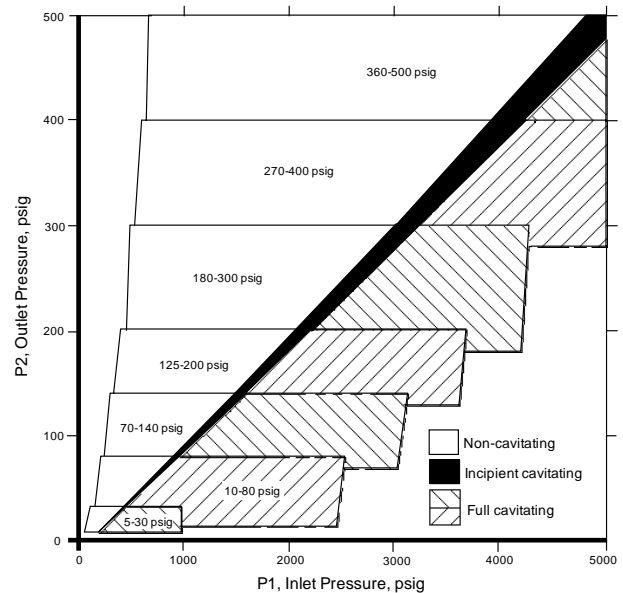

DIMENSIONS AND WEIGHTS

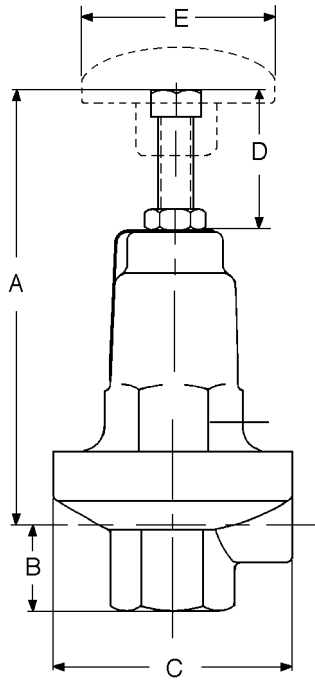

ENGLISH UNITS (inches)						
Body Size 1/4"	A	B	C	D	E	Shipping Weight
Standard	4.50	.91	2.50	—	—	3 lbs.
-2 (Handwheel)	4.88	.91	2.50	—	1.50	
-22 (Panel Mount)	4.88	.91	2.50	2.06	1.50	
-2+80 (Handwheel + High Outlet Pressure)	7.62	.91	2.50	—	4.0	5 lbs.
-22-80 (Panel Mt. + High Outlet Pressure)	7.62	.91	2.50	2.75	4.0	
-80 (High Outlet Pressure)	6.88	.91	2.50	—	—	
METRIC UNITS (mm)						
Body Size DN8	A	B	C	D	E	Shipping Weight
Standard	114	23	64	—	—	1.36 kgs.
-2 (Handwheel)	124	23	64	—	38	
-22 (Panel Mount)	124	23	64	52	38	
-2+80 (Handwheel + High Outlet Pressure)	194	23	64	—	102	2.27 kgs.
-22 + 80 (Panel Mt. + High Outlet Pressure)	194	23	64	70	102	
-80 (High Outlet Pressure)	175	23	64	—	—	

PRODUCT CODE 03/15/99

TABLE 2

BODY / SP. CH.	OPTION	CODE
SST/BRZ	Std.	8
SST/SST	-60	A

TABLE 1

SIZE	ORIFICE	CODE
1/4"	0.109"	2
1/4"	0.156"	J

TABLE 3

STAINLESS STEEL TRIM	
DESIG.	CODE
S1	S1
S3 *	S3
S40 *	40
S40M	4M

TABLE 4

STEEL RANGE SPRING (psig)	CODE
10-80	1
70-140	2
125-200	3
180-300	4
270-400 *	5
360-500 *	6
5-30	A

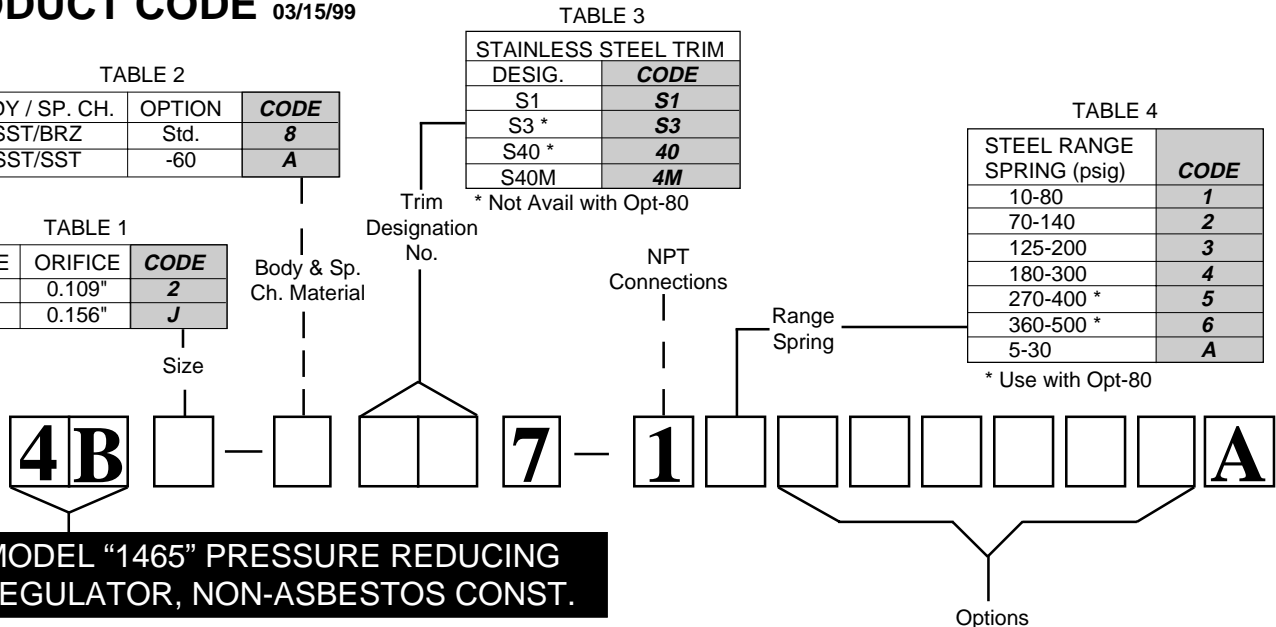

MODEL "1465" PRESSURE REDUCING REGULATOR, NON-ASBESTOS CONST.

TABLE 5

DESCRIPTION	OPTION	CODE
SPECIAL CONSTRUCTION	—	X
HANDWHEEL	-2	2
PANEL MOUNTING (Includes Handwheel)	-22	C
NACE CONSTRUCTION: SST/SST/XX Per MR0175, S40 and S40M Trims Only. NOT AVAIL w/-80 Opt.	-40 SST	K
SPECIAL CLEANING: Per Cashco Spec #S-1134.	-55	M
HIGH PRESSURE SPRING CHAMBER CONSTRUCTION	-80	U